

One-touch fittings—threaded type

Ordering code

BB 01 01 □

① ② ③ ④

① Model	② Thread connection I	③ Thread connection II	④ Thread type
BB: Male connector 	BD: Male & female connector[Note1] 	BU: Double female connector 	BZ: Hexagon head cap plug[Note2]
	01: 1/8" 02: 1/4" 03: 3/8" 04: 1/2"	01: 1/8" 02: 1/4" 03: 3/8" 04: 1/2"	Blank: PT

[Note1] For BD series, Thread I is Female thread, Thread II is male thread; [Note2] For BZ series, no thread II and thread I is male thread.

Specification

Operating pressure range	0~10kgf/cm ² (0~1.0MPa)
Negative pressure	-750mmHg(10Torr)
Proof pressure	3.0MPa
Ambient and fluid temperature (°C)	0~150

Configuration table of tubing thread

Product series	Thread connection I	Thread connection II			
		01	02	03	04
BB	01	●	●	●	
	02		●	●	●
	03			●	●
	04				●
BD	01		●	●	●
	02			●	●
	03				●
	04				
BU	01	●			
	02		●		
	03			●	
	04				●
Product series	Thread connection				
	01	02	03	04	
BZ	●	●	●	●	

Product feature

- Variable models can be widely used in every kind of pneumatic systems.
- High circulation performance bear the same flow with the volume of the tube innerdiameter.
- The nickel plated body is anti-corrosion and anti-pollution, which allows a broader application.
- Metal fittings can be used in high temperature environment.

Dimensions

BB Series

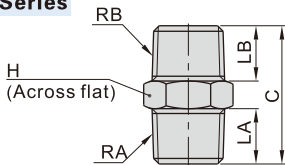

Model\Item	RA	RB	LA	LB	C	H	Weight(g)
BB0101	1/8"	1/8"	7.5	7.5	19.5	10	6.6
BB0102	1/4"	1/8"	10	7.5	22.5	14	12.1
BB0103	3/8"	1/8"	11	7.5	24	17	18.3
BB0202	1/4"	1/4"	10	10	25	14	14.6
BB0203	3/8"	1/4"	11	10	26.5	17	20.3
BB0204	1/2"	1/4"	14	10	30	21	34.3
BB0303	3/8"	3/8"	11	11	27.5	17	23.2
BB0304	1/2"	3/8"	14	11	31	21	36.2
BB0404	1/2"	1/2"	14	14	34	21	42.8

BD Series

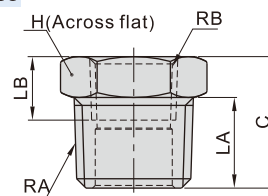

Model\Item	RA	RB	LA	LB	C	H	Weight(g)
BD0102	1/4"	1/8"	10	8	14.5	14	8.8
BD0103	3/8"	1/8"	11	8	16	17	17.1
BD0104	1/2"	1/8"	14	8	19.5	21	33.1
BD0203	3/8"	1/4"	11	11	16	17	12.7
BD0204	1/2"	1/4"	14	11	19.5	21	29.9
BD0304	1/2"	3/8"	14	12	19.5	21	22.5

BU Series

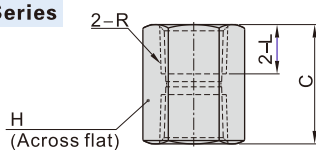

Model\Item	R	L	C	H	Weight(g)
BU0101	1/8"	8	17	12	8.4
BU0202	1/4"	11	23	17	25.4
BU0303	3/8"	12	25	21	40
BU0404	1/2"	13.5	28	24	46.6

BZ Series

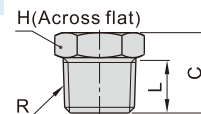

Model\Item	R	L	C	H	Weight(g)
BZ01	1/8"	7.5	11	10	4.6
BZ02	1/4"	10	14.5	14	10.8
BZ03	3/8"	11	16	17	17.4
BZ04	1/2"	14	19.5	21	33